

FRS060-360

Rotary Stage

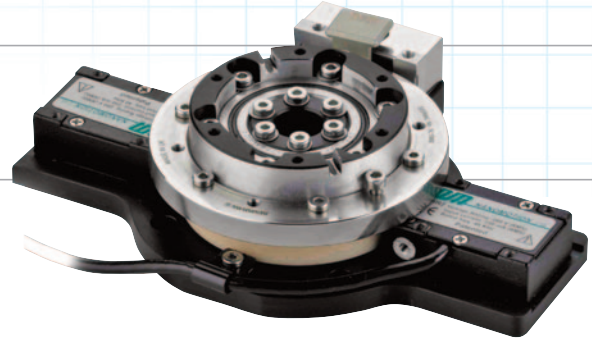

Mechanical Design Characteristics

MODEL	FRS060-360
Stage Plate Material	Aluminum — Black Anodized
Motor	2 x HR2 Piezo, ultrasonic standing wave
Bearing Type	Precision crossed roller rotary bearing
Encoder	Linear optical encoder with metal ring
Cable Lengths (m)	3m
MTBF (hours)	30,000
Stage Mass (g)	581g
Moving Mass (g)	268g
Moving Inertia	0.102 gr-m ²
RoSH	Compliant
Vacuum Compatible Options	High Vacuum (to 10 ⁻⁷ Torr) / UHV (to 10 ⁻¹⁰ Torr) available

Performance Specifications

MODEL	FRS060360
Travel Range (mm)	n x 360
Encoder Resolution	Standard 5 arc sec.
	Optional 0.5 arc sec.
Bi-directional Repeatability	Standard 50 arc sec.
	Optional 5 arc sec.
Accuracy	Standard (arc sec.) 10 arc sec.
	Optional (arc sec.) 5 arc sec.
Maximum Velocity	8.3 rad/sec
Flatness	±5µm
Load Inertia Capacity	0.0035kg.m ²
Load Capacity - Moment	2kg
Dynamic Stall Force	0.96Nm
Stage Stiffness	0.0032 Nm/µrad
Holding Force without Power	0.86Nm

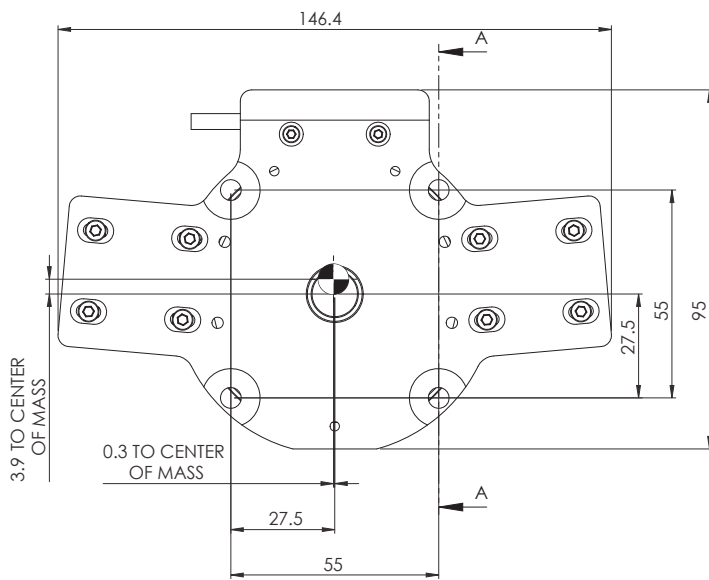

MOUNTING HOLES
4x 3.5

MOUNTING HOLES
4x ϕ 10
MOUNTING HOLES
4x ϕ 5.5

SECTION A-A

